

NB Ash Dieback Disease

Ash dieback is a serious disease of ash trees caused by the fungal pathogen *Hymenoscyphus fraxineus* (previously known as *Chalara fraxinea*). Although only 3 specimen shows early signs of the disease **it must be anticipated that the national pattern of spread be realised on this site in the coming years.** With the safety & amenity of the future residents of this development the priority, it is recommended that all Ash specimens be felled.



LEGEND - TREES

All measurements are approximate & noted in meters.

No.	Species (Botanic Name)	Common Name	Height	Spread	Stems	Stem Diameter
PINK TO BE REMOVED						
1	<i>Fraxinus excelsior</i>	Common Ash	8-10	6-8	1	.25
2	<i>Fraxinus excelsior</i>	Common Ash	8-10	4-6	1	.2
3	<i>Betula pendula</i>	Silver Birch	6-8	3-5	1	.15
4	<i>Fraxinus excelsior</i>	Common Ash	6-8	4-6	1	.15
5	<i>Fraxinus excelsior</i>	Common Ash	6-8	4-6	1	.2
6	<i>Betula pendula</i>	Silver Birch	6-8	3-5	1	.15
7	<i>Fraxinus excelsior</i>	Common Ash	8-10	6-8	1	.25
8	<i>Fraxinus excelsior</i>	Common Ash	8-10	6-8	1	.20
9	<i>Crataegus monogyna</i>	Hawthorne	4-6	4-6	1	.1
10	<i>Fraxinus excelsior</i>	Common Ash	6-8	4-6	1	.2
11	<i>Fraxinus excelsior</i>	Common Ash	6-8	4-6	1	.15
12	<i>Fraxinus excelsior</i>	Common Ash	10-12	8-10	5	.3
13	<i>Fraxinus excelsior</i>	Common Ash	8-10	6-8	1	.3
14	<i>Samucus nigra</i>	Common Elder	4-6	6-8	7	.2/.3
15	<i>Crataegus monogyna</i>	Hawthorne	5-6	4-6	1	.2
16	<i>Crataegus monogyna</i>	Hawthorne	5-6	3-4	3	.15

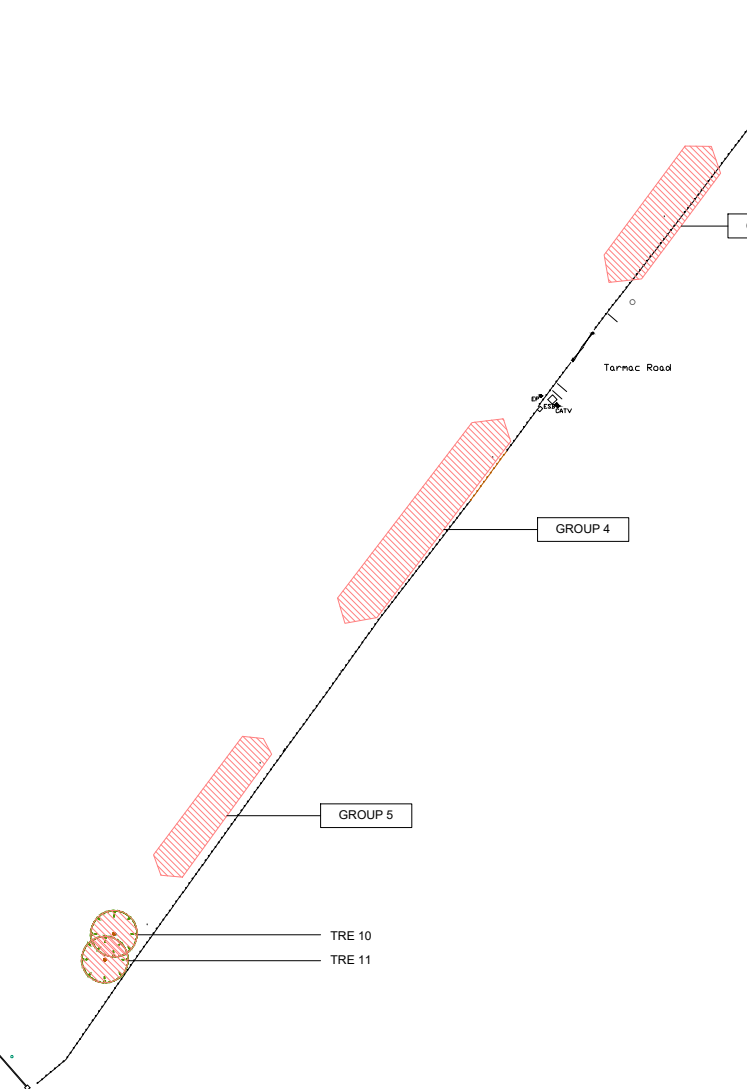
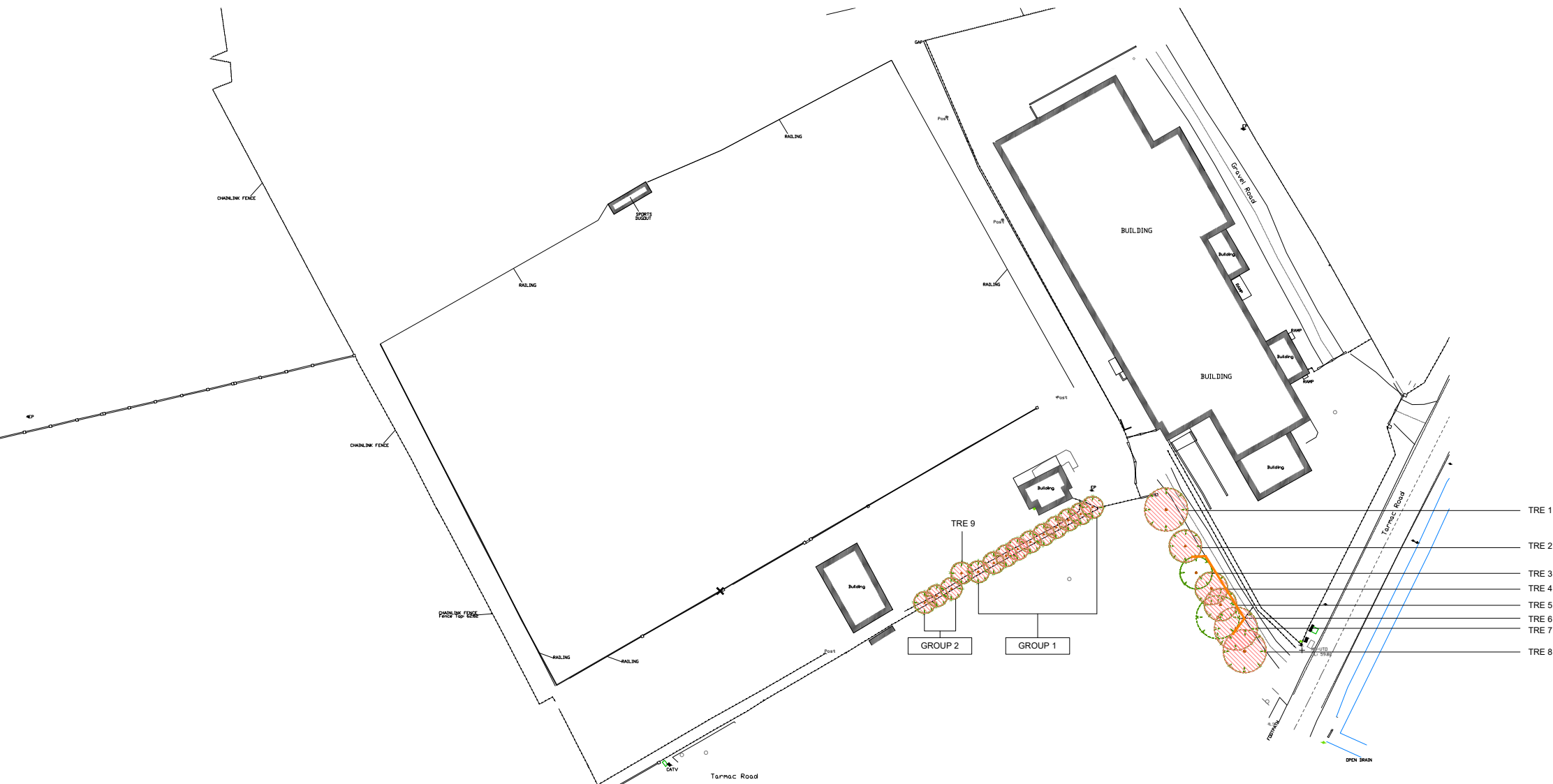

PROTECTIVE FENCING TO RED LINE

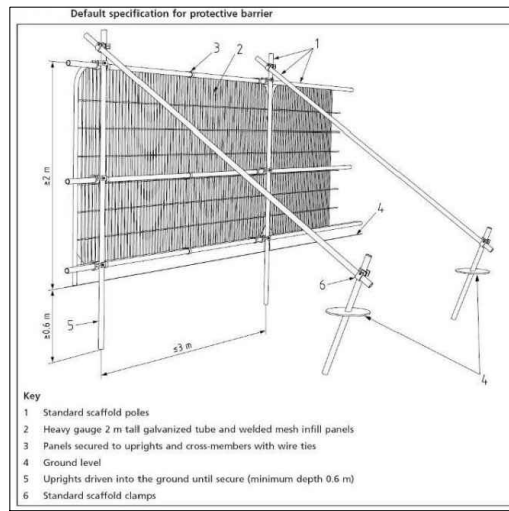

TREES - Retention/Removal

- Specimen trees to be retained & protected'
- Specimen trees to be removed due to threat of disease or to accommodate proposed development.

Tree Protection Fence Line
(for duration of construction works)

PROTECTIVE FENCING SIGNAGE

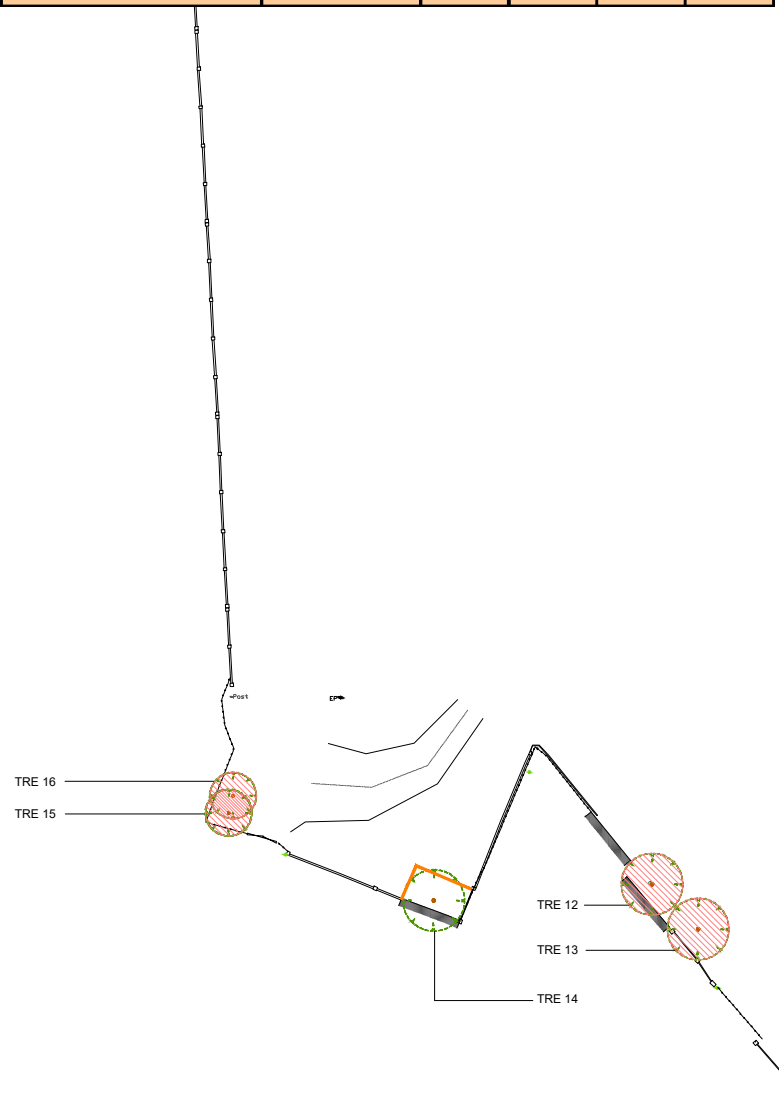

The Clay, Ballinlea, Donard, Co. Wicklow, Ireland.	Tel: 087 2869180 E Mail: aj@anthonyjohns.com Web: www.anthonyjohns.com	PROJECT 148 UNIT RESIDENTIAL MIXED HOUSING DEVELOPMENT	DRAWING TITLE TREE RETENTION/PROTECTION & REMOVAL - REVISED TO ACCOMMODATE RFI REQUIREMENTS
		ANTHONY JOHNS NDH LANDSCAPE DESIGN LTD	DWG NO. FLA-WEL/TRR/001b
		PROJECT ADDRESS PUTTAGHAN LANDS, ARDEN, TULLAMORE, CO. OFFALY.	SCALE 1:1000 @ A3
		CLIENT JOHN FLANNAGAN DEVELOPMENTS LTD	DRAWN AJ CHECKED RM
			DATE 29.8.23 REF DR
All measurements to be checked on site. All areas refer to Bill of Quantities.			